

CHAPTER 4  
PREPARATION FOR RESHIPMENT/STORAGE

4-1. GENERAL

All preventive maintenance checks and services should be performed on container prior to any storage or shipment.



## CHAPTER 5

### ILLUSTRATED REPAIR PARTS LIST

#### Section I INTRODUCTION

##### 5-1. GENERAL

The Illustrated Repair Parts List contains breakdowns for all groups, assemblies and subassemblies which can be disassembled, reassembled and replaced. All parts are listed in disassembly sequence, except where the sequence of disassembly does not apply.

##### 5-2. EXPLANATION AND USE OF COLUMNS

- a. ITEM NO. The number used to identify each item called out in the illustration.
- b. CAGEC NO. The Commercial And Government Entity Code is a five digit code listed in SB708-42 which is used to identify the manufacturer, distributor, or Government agency whose part number is used to identify the part.
- c. PART NUMBER. The first part number listed indicates the primary control number which controls the design and characteristics of the item by means of its engineering drawing, specification, or standard. When additional part numbers are listed, this indicates that the first part number is a Specification Control drawing and that the part is available from the company whose CAGEC is listed opposite that number.
- d. DESCRIPTION. The item name and, if required, a minimum description to identify the item.
- e. U/M (Unit of Measure). Indicates the standard of the basic quantity of the listed item as used in performing the actual maintenance function. This measure is expressed by a two-character alphabetical abbreviation (e.g., ea, in, pr, etc.). When the unit of measure differs from the unit of issue, the lowest unit of issue that will satisfy the required units of measure will be requisitioned.
- f. QTY (Quantity). Indicates the quantity of the item used in the breakout shown on the illustration figure. A "V" appearing in this column in lieu of a quantity indicates that no specific quantity is applicable (e.g., shims, spacers, etc.).

**5-3. DIFFERENCES BETWEEN UNITS**

All significant differences between units will be defined by unit serial number, in footnotes on the page of the effected part listing. Should major design/model changes be made, a descriptive statement can be added following this paragraph identifying usable on codes. These usable on codes can then be added to the repair parts list following the description to reflect differences for part ordering information.

SECTION II REPAIR PARTS LIST WITH ILLUSTRATED PARTS BREAKDOWN

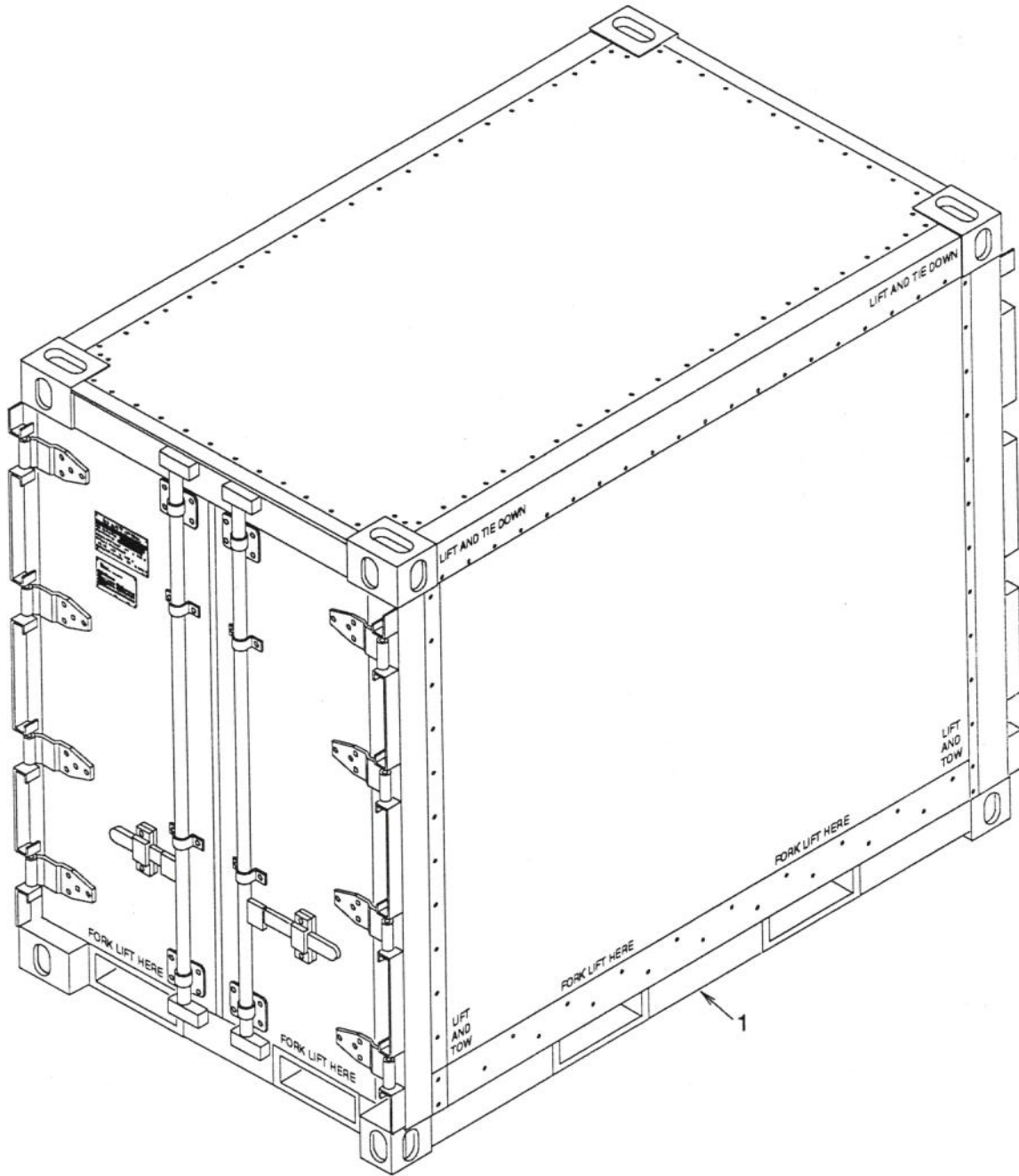

Figure 5-1. Quadruple Container (QUADCON)

ITEM NO.	CAGEC	PART NUMBER	DESCRIPTION	U/M	QTY
1	94833	138K0000-1	FIGURE 5-1. QUADRUPLE CONTAINER (QUADCON) QUADRUPLE CONTAINER (QUADCON).....	EA	1

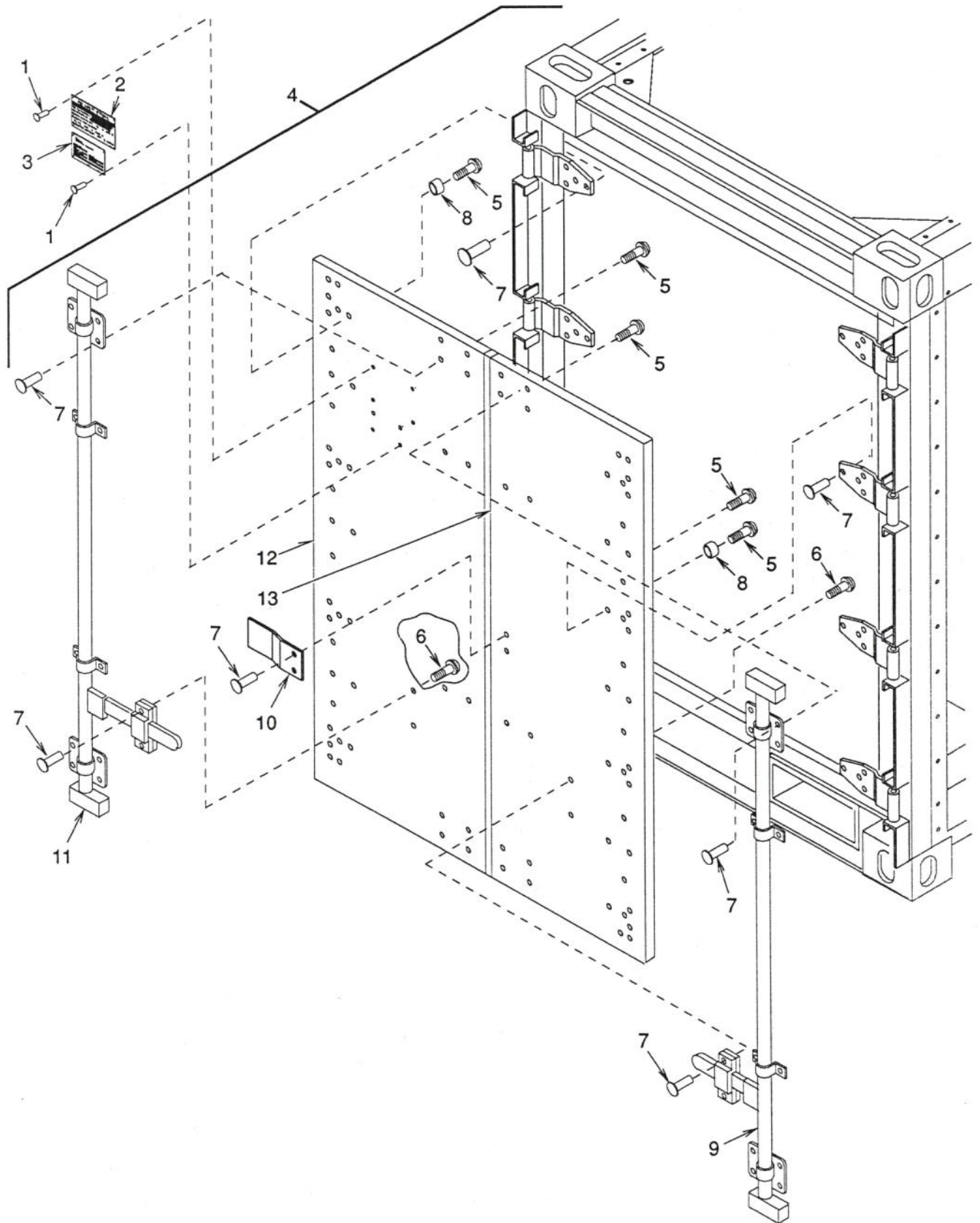

Figure 5-2. Doors



ITEM NO.	CAGEC	PART NUMBER	DESCRIPTION	U/M	QTY
			FIGURE 5-2. DOORS		
1	94833 94222	138K0014-1 38-104-09-93	• DRIVE RIVET .....	EA	8
2	94833	138K0004	• PLATE, CONVENTION .....	EA	1
3	94833	138K0003	• PLATE, IDENTIFICATION.....	EA	1
4	94833	138K0030-1	• DOOR ASSEMBLY .....	EA	2
5	94833 OJ3U8	138K0013-4 F8719589-0209	• • SCREW, WASHER HEAD .....	EA	4
6	94833 OJ3U8	138K0013-5 F8719999-0201	• • SCREW, WASHER HEAD .....	EA	58
7	94833 OJ3U8	138K0012 F9919348-100	• • T NUT, PRESS-IN.....	EA	62
8	94833	138K0091-4	• • BUSHING.....	EA	32
9	94833	138K0010	• • LOCK, DOOR, RIGHT HAND .....	EA	1
10	94833	138K0015	• • STOP, DOOR .....	EA	1
11	94833	138K0011	• • LOCK, DOOR, LEFT HAND .....	EA	1
12	94833	138K0099-1	• • DOOR, L.H. ....	EA	1
13	94833	138K0099-2	• • DOOR, R.H. ....	EA	1

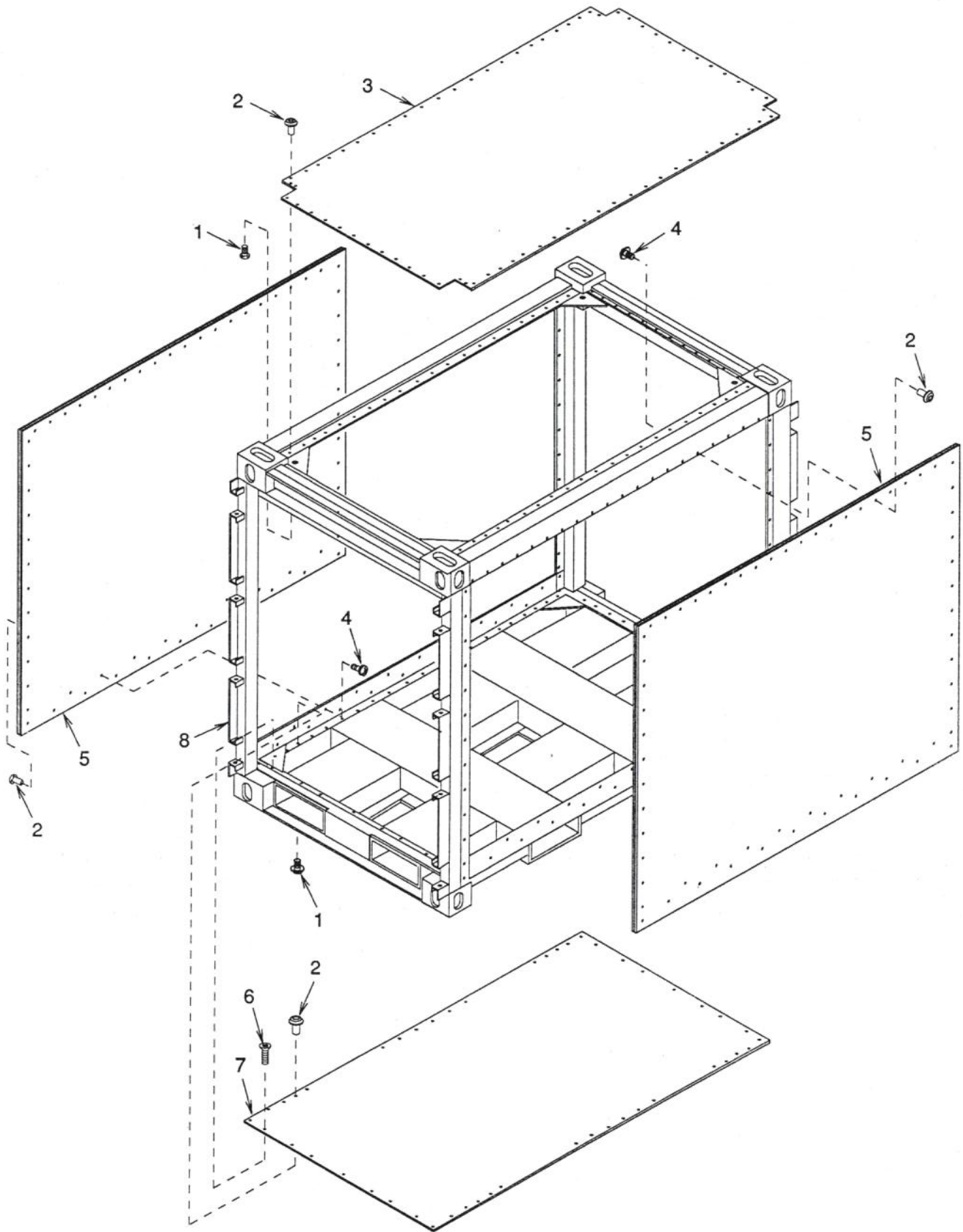

Figure 5-3. Panels



ITEM NO.	CAGEC	PART NUMBER	DESCRIPTION	U/M	QTY
1	94833 OJ3U8	138K0013-1 F8719349-0209	FIGURE 5-3. PANELS • SCREW, WASHER HEAD .....	EA	98
2	94833 OJ3U8	138K0012 F9919348-100	• T NUT, PRESS-IN.....	EA	256
3	94833	138K0006	• ROOF.....	EA	1
4	94833	138K0013-2	• SCREW, WASHER HEAD .....	EA	158
5	94833	138K0007	• WALL.....	EA	2
6	94833	138K0016	• SCREW, FLAT HEAD.....	EA	46
7	94833	138K0008	• FLOOR.....	EA	1
8	94833	138K0005	• QUADCON WELDMENT.....	EA	1

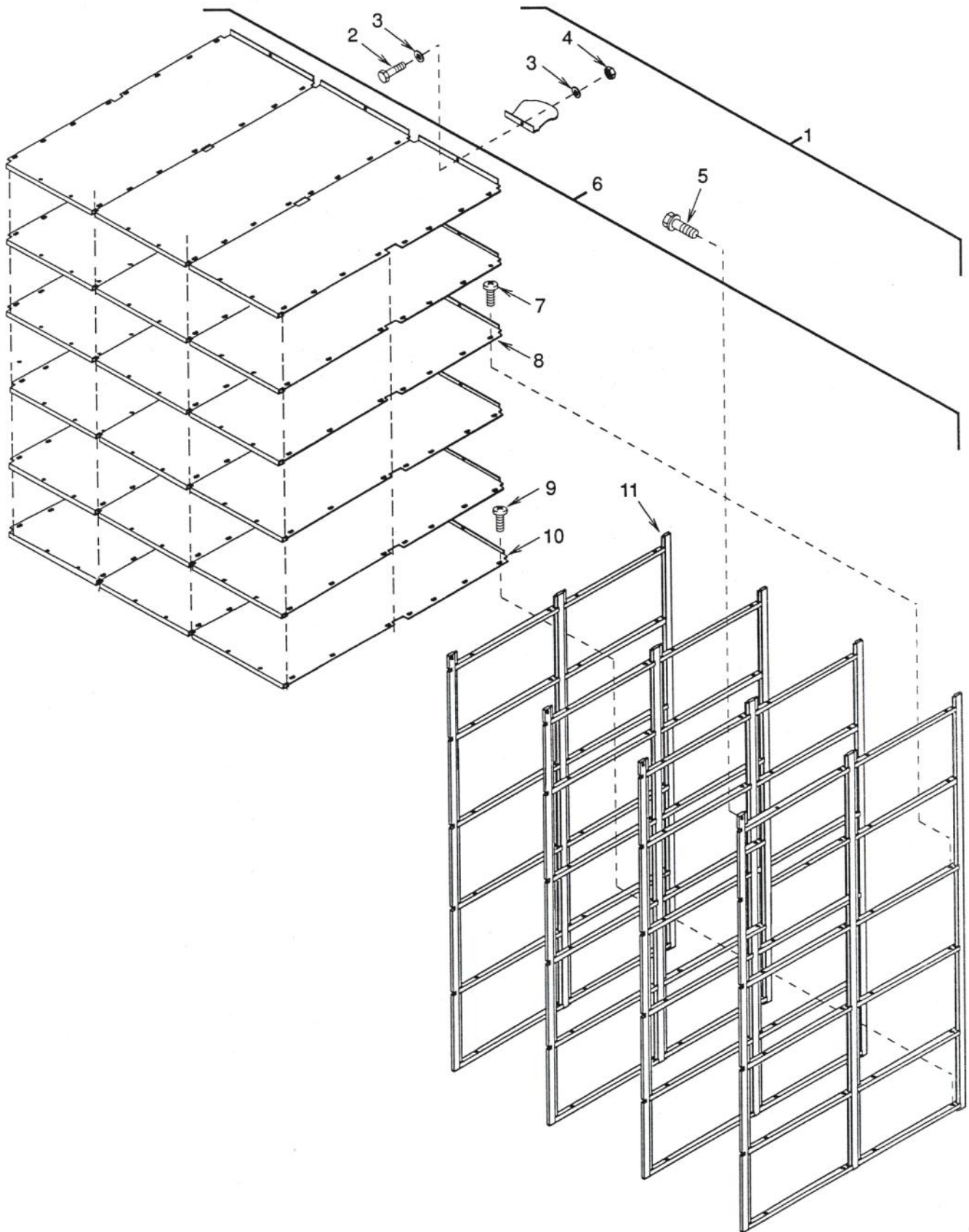

Figure 5-4. Rack

ITEM NO.	CAGEC	PART NUMBER	DESCRIPTION	U/M	QTY
			FIGURE 5-4. RACK		
1	94833	138K0060-1	RACK ASSEMBLY/INSTALLATION .....	EA	1
2	88044	AN3-6A	• BOLT, HEX HD .....	EA	18
3	96906	MS27183-42	• WASHER, FLAT-ROUND .....	EA	36
4	96906	MS21044N3	• NUT, SELF-LOCKING HEX.....	EA	18
5	16004	88338	• BOLT, HEX WASHER HD .....	EA	4
6	94833	138K0061-1	• RACK-HALF ASSEMBLY .....	EA	2
7	94833 OJ3U8	138K0079-4 F2912504-9892	• • SCREW, THREAD FORMING.....	EA	160
8	94833	138K0089-1	• • SHELF, UPPER.....	EA	15
9	94833 OJ3U8	138K0079-6 F2912244-9892	• • SCREW, THREAD FORMING.....	EA	16
10	94833	138K0090	• • SHELF, BOTTOM.....	EA	3
11	94833	138K0070-1	• • SIDE FRAME.....	EA	4

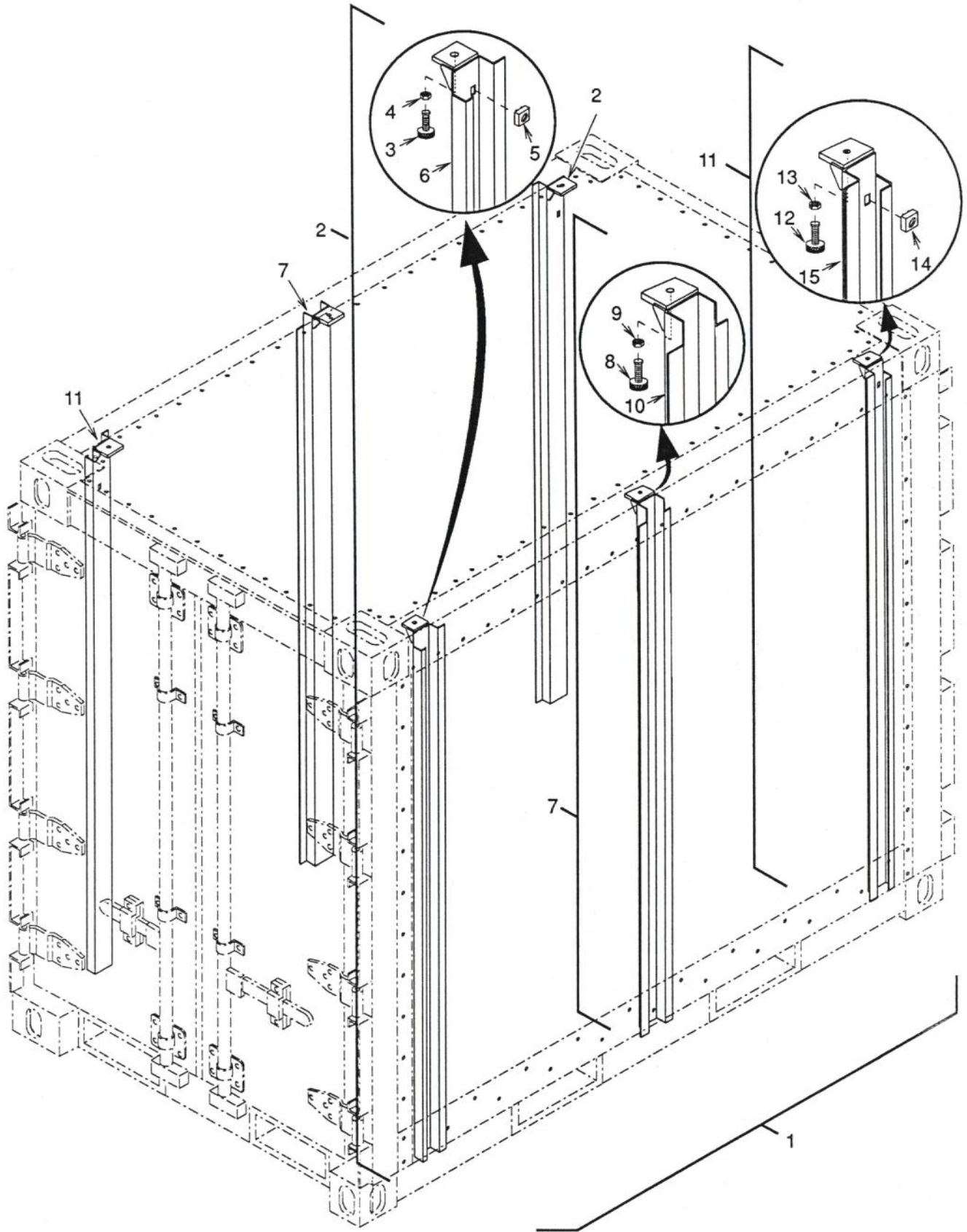

Figure 5-5. Rack Beams



ITEM NO.	CAGEC	PART NUMBER	DESCRIPTION	U/M	QTY
			FIGURE 5-5. RACK BEAMS		
1	94833	138K0071-1	• RACK INSTALLATION KIT.....	EA	1
2	94833	138K0077-2	•• END BEAM ASSEMBLY .....	EA	2
3	94833 99862	138K0078 CL-21-SHS-S	••• SCREW, CLAMPING .....	EA	1
4	96906	MS35649-2252	••• NUT, JAM.....	EA	1
5	97403 89032	13211E8201-7 C7998-1420	••• NUT, CAGE .....	EA	1
6	94833	138K0074-2	••• END BEAM.....	EA	1
7	94833	138K0059-1	•• CENTER BEAM ASSEMBLY .....	EA	2
8	94833 99862	138K0078 CL-21-SHS-S	••• SCREW, CLAMPING .....	EA	1
9	96906	MS35649-2312	••• NUT, JAM.....	EA	1
10	94833	138K0072-1	••• CENTER BEAM.....	EA	1
11	94833	138K0077-1	•• END BEAM ASSEMBLY .....	EA	2
12	94833 99862	138K0078 CL-21-SHS-S	••• SCREW, CLAMPING .....	EA	1
13	96906	MS35649-2312	••• NUT, JAM.....	EA	1
14	97403 78553	13211E8201-7 C7998-1420	••• NUT, CAGE .....	EA	1
15	94833	138K0074-1	••• END BEAM.....	EA	1

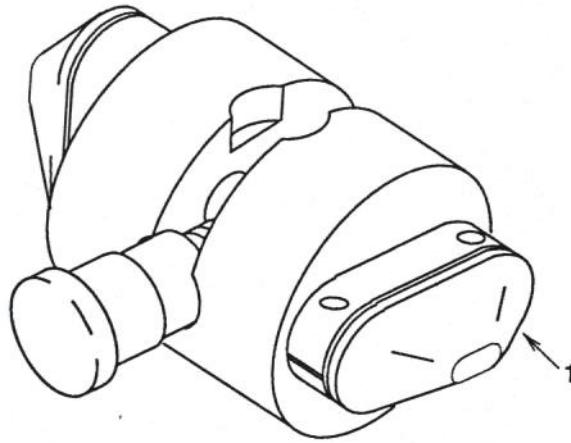

Figure 5-6. Rigid Connecting Link

ITEM NO.	CAGEC	PART NUMBER	DESCRIPTION	U/M	QTY
1	94658 94833	CTC-1012-23-1 138K0080	FIGURE 5-6. HORIZONTAL CONNECTOR, QUADCON CONNECTING LINK, RIGID .....	EA	AR



## ALPHABETICAL INDEX

### C

Capabilities and Features, 1-2  
Connecting Containers, 2-3

### D

Differences Between Models, 1-5  
Differences Between Units, 5-3  
Door Replacement, 3-8

### E

Explanation and Use of Columns, 5-2

### F

Finish Paint, 3-10

### I

Introduction, Inspection, and Service, 3-2

### L

List of Items Furnished, 1-7  
List of Items Required, 1-8  
Location and Description of Major Components, 1-3  
Lubrication, 3-3

### M

Marking, 2-4  
Minor Dents and Punctures, 3-7

### P

Panel Replacement, 3-9  
Performance Data, 1-6  
Preventive Maintenance Checks and Services, 3-4

### R

Rack Beam Installation, 3-11  
Rack Half Assembly, 3-12  
Rack Installation, 3-14  
Rack Removal/Disassembly, 3-15  
Rack To Rack Assembly, 3-13  
Receiving Inspection, 2-2

### S

Scope, 1-1  
Special Tools, 3-6

### T

Tools and Test Equipment, 1-9

### U

Unloading, 2-1

### W

Warnings, 1-11  
Warranty, 1-4

